

## 21.5inch Stand-type POS Machine Payment Terminal Suitable for Fast Food Restaurants

Our Product Introduction

for more products please visit us on [monitorspcs.com](http://monitorspcs.com)

### Basic Information

- Place of Origin: CHINA
- Brand Name: OEM/ODM
- Certification: CE FCC ROHS
- Minimum Order Quantity: 1
- Price: 500
- Delivery Time: 8
- Payment Terms: T/T
- Supply Ability: 10000



### Product Specification

- Color: White
- Interface: HD+RJ45+VGA+USB
- Status: New
- Touch: Capacitive Touch
- Brightness: 300nit
- Material: Metal Case
- Highlight: 21.5 inch POS machine for restaurants, stand-type payment terminal for fast food, touch screen POS monitor with warranty



### More Images



## Product Description

### 21.5-Inch Vertical POS Terminal: Streamline Operations for Busy Business Spaces

#### Core Advantages of This Compact All-in-One Terminal

##### Clear Display & Smooth Touch Interaction

Equipped with a 21.5-inch Full HD (1920×1080) IPS touchscreen, it delivers vivid colors and wide viewing angles—content stays sharp from any side. The 10-point capacitive touch responds instantly, handling fast-paced interactions even during peak business hours.

##### Space-Saving Integrated Setup

Its vertical, all-in-one housing combines a built-in thermal printer and multi-payment module (supports card swiping, QR code scanning) in one unit. No extra devices or tangled cables: customers can finish selecting, paying, and getting receipts in one seamless step, while your counter stays clutter-free.

##### Durable Build for Daily Heavy Use

The screen uses scratch-resistant, anti-impact glass (5–10x more impact-resistant than standard glass) to stand up to daily wear. It also tolerates over 150°C temperature differences, staying reliable in both warm dining areas and cooled retail spaces.

##### Versatile for Multiple Scenarios

Ideal for small restaurants, convenience stores, clinic check-in desks, and bank service counters. Its 24/7 operational capability cuts manual work and speeds up transactions in high-turnover environments.

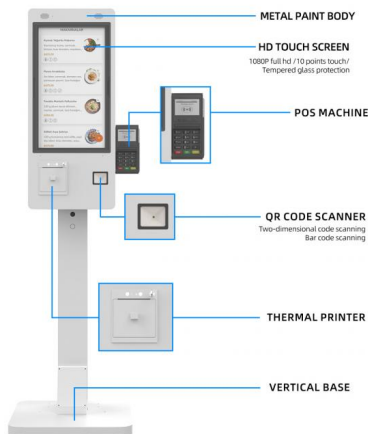
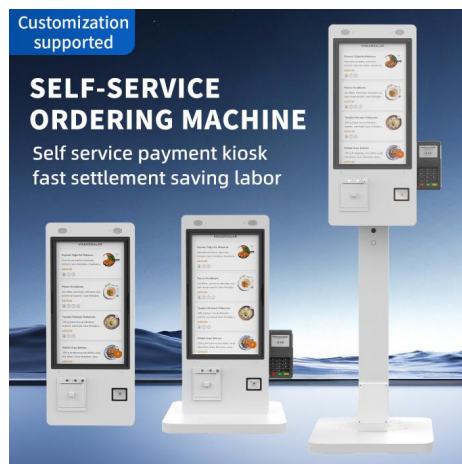

#### SUPPORT VARIOUS CUSTOMIZATIONS



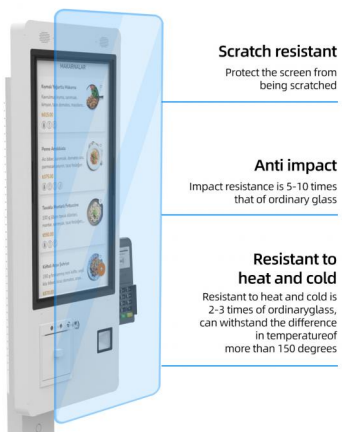

**Q: How can I get the price?**

A: We usually give you a quotation within 24 hours after receiving the inquiry (except weekends and holidays), if you need a quotation urgently, you can contact us by mail or other means.

**Q: What is the minimum order?**

A: Our company mainly deals in wholesale business, but if you insist on buying one, or you only need one set, we will also deliver the goods to you.

**Q: Can I buy a prototype to test before buying in bulk?**

A: Yes, please feel free to contact us.

**Q: What payment methods do you accept?**

A: Our company supports most payment methods, but usually accepts T/T, PayPal.

**Q: What are your shipping methods?**

A: We support sea, air, rail transportation, and express delivery, and also support customers to use their own logistics forwarders. Please confirm with us before placing an order.

**Q: I would like to ask you if it's possible to have my logo on the product.**

A: Yes, we support OEM and special customization, so we can design, produce, and process according to customer's requirements. Of course, custom logos on the box and instruction manual are also included.

**Q: What is your delivery time?**

A: It depends on your order quantity and order season. Usually, small quantities will be shipped within 5 to 15 days, and large quantities will be delivered within about 30 days. All in all, the delivery time will not exceed the time agreed between us and the buyer.



**Touch Vision (Shenzhen Sufeida) Technology Co., Ltd.**



+86 19925413433



cnsfdxhl@monitortp.com



monitorspcs.com

605, Workshop C, No.1, East Industrial District, Shangxue Science park, Xinxue Community, Bantian Street, Longgang District, Shenzhen, China